

PA GIS

Conference

Reminders

As we are gearing up for the PA GIS Conference, here are a few reminders:

1- The Pennsylvania NHD Committee will be meeting at this year's PAGIS Conference during the INFOSWAP on Tuesday, May 22<sup>nd</sup>. Committee members not registered for the GIS conference can still attend the INFOSWAP.

2- If you or your company is interested in sponsoring the InfoSwap, please contact Eric Jespersen at [ecj@epix.com](mailto:ecj@epix.com)

3- Voting for open Board positions will start on May 14 using an electronic survey.

# PAMAGIC MATTERS

MAY 2012

## President's Letter

Things have been very busy recently throughout the Pennsylvania GIS community. In particular, we are in the final stages of planning the PA GIS Conference and House Bill 1701 continues to progress through the legislative process. Both of these items have required a great deal of time and energy from a wide variety of people and organizations, and the work is very much appreciated.

The PA GIS Conference is shaping up to be another successful event. An exciting Program has been developed, including a wide variety of sessions and presentations representing a broad spectrum of GIS activities. In addition, the keynote and plenary speakers will provide interesting perspectives and insights.

There will be new activities, such as lightning talks and a Maps/Apps contest, and the typical (but fun and beneficial) activities like our annual InfoSwap. I look forward to seeing you all at the Conference!

I'd also like to take a moment to thank those of you who provided input for the State of the GIS Report. For those of you who haven't yet, we will continue to accept input any time you have it. We see this as an ongoing Report and will always welcome input. We plan on having the results thus far summarized and available at the GIS Conference.

Other information, activities and upcoming events are listed in this Newsletter and we hope you find this useful and interesting. Please don't forget to visit (and "Like") PA MAGIC on Facebook and to follow us on Twitter!



**PAMAGIC President**  
**Mike Bialousz**

## Find your State Park in a Whole New Way!

In early April, a new [interactive map](#) was released to the Department of Conservation and Natural Resources web site. The map is focused on providing a wide variety of information and search tools related to Pennsylvania State Parks. Use the map to quickly obtain a wide variety of

Park information, find Parks by amenities or geographic region, get driving directions, get weather forecasts, create and print maps, view Parks with a wide variety of map types, obtain/share data, and more. This is the first of many planned interactive map deployments that will encom-

pass all DCNR business areas – next up is State Forests which is scheduled to be released in July. Check it out and spread the word! For more information or if you have questions, feel free to contact Mike Bialousz at [mbialousz@pa.gov](mailto:mbialousz@pa.gov).

## PAMAGIC BOARD

### President

Mike Bialousz  
Department of Conservation and Natural Resources  
mbialousz@pa.gov

### Treasurer

Eric Jespersen  
Fisher Associates  
ecj@epix.com

### Secretary

Dave Gilbert  
GeoDecisions  
dgilbert@geodecisions.com

### Board Member

Glenn Mohler  
Lancaster County GIS  
mohler@co.lancaster.pa.us

### Board Member

Tom Denton  
Office for Research and Planning—  
Archdiocese of Philadelphia  
tdenton@adphila.org

### Board Member

Nicole Ernst  
Harrisburg Area Community College  
nlernst@hacc.edu

### Board Member

Kathryn Reed  
Allegheny County GIS  
kathryn.reed@allegheycounty.us

### Board Member

Laura Simonetti  
Mifflin County GIS  
lsimonetti@co.mifflin.pa.us

Keep up with the latest  
**PAMAGIC** news! Find  
us on Facebook, follow  
us on Twitter, and  
check out our website!



## ESRI CityEngine

[Esri CityEngine](#) is a 3D modeling software application that was developed by the Esri R & D Center Zurich. This software application allows for the generation of 3D urban environments and for the creation of detailed large-scale city models. It has been used to model medieval cities, visualize master planning, assess real estate, to name a few [potential applications](#).

CityEngine is available for all platforms and can be licensed for both single use or concurrent use. CityEngine Basic is \$500 (single use licensing only) and the Advanced is 4,000. A [trial version](#) is available, so try it today!

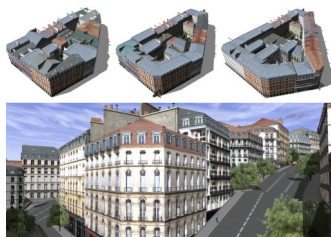

## Calendar of Events

**Esri MUG Meeting**—May 17 from 9am-12pm at Microsoft technology center, 45 Liberty Boulevard, Malvern, PA 19355

**PA GIS Conference**— May 22-23

**Esri User Conference**—July 23-27

**Central PA GIS Day**—November 14

**Esri MUG 2012 Annual Conference**—December 11-12

If you have an event that you would like to share with the PA GIS community, email it to our [newsletter editor](#).